

STILL

SUKHUMVIT 20



SILENT · TIMELESS · STILL

In a world of noise and constant motion, STILL represents a new language of prestige: Silent and Timeless in Luxury Living. This is not luxury that shouts, but one that speaks softly — through the calm of timeless design, the serenity of curated spaces, and the comfort of a home that understands you.

Created for individuals who value taste over display and heritage over trends, STILL is where stillness itself becomes the ultimate status — a sanctuary of elegance in the heart of Sukhumvit.

PROJECT INFORMATION

Project Name	STILL Sukhumvit 20
Land Area	2-0-87.4 Rais
Project Type	30-storey Residential Building
Total Units	124 Residential Units 1 Commercial Unit
Parking	Conventional Parking 217 Cars
Unit Types	
2 Bedrooms	85 - 124 sq.m.
3 Bedrooms	134 - 218 sq.m.
3 Bedrooms Corner Suite	217 - 235 sq.m.
Junior Penthouse	163 - 321 sq.m.
Penthouse	439 sq.m.

FACILITIES

Ground Floor
Foyer of the House, Living Room, Conservatory Room,
Business Lounge, Pet Yard and Collector's Garden

8th Floor
IN-HOUSE RETREAT
Retreat Lounge, Spa, Onsen, Playroom, Dressing Room,
Orangery Dining Lounge, Grill Yard and The 8th Terrace

26th -27th Floor
HEALTH CLUB IN RESIDENCE
Poolside Lounge, Home Gym, STILL Pool, Kid's Pool, Thermal Pool,
Pilates & Yoga Studio, Movie Room and Golf Room



A Computer Generated Image for Advertising Purpose Only

FLOOR PLAN



Ground Floor

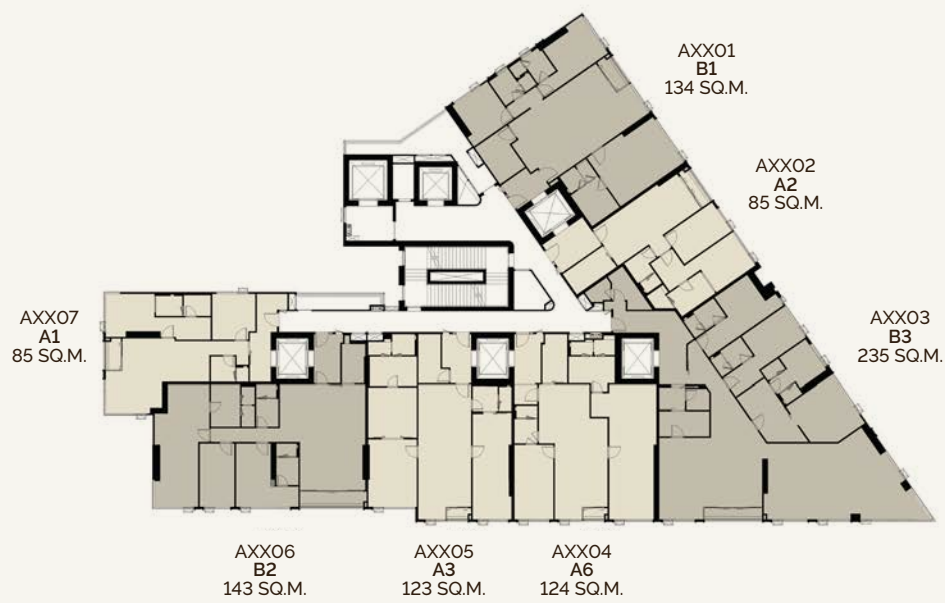

Floor 9th — 22nd



Some addresses speak for themselves. Main Road Sukhumvit is one of them — rare, prestigious, and deeply connected to the rhythm of Bangkok. STILL is surrounded by the city's finest: the EM District at your doorstep, green sanctuaries like Benchakitti Forest Park and Benchasiri Park, and the convenience of international schools, world-class hospitals, and expressway access.

It is a location that balances vitality with serenity, offering you the privilege of living at the heart of it all, while always returning to a sanctuary of stillness.

STILLNESS IN THE HEART OF SUKHUMVIT

